

DISTRIBUCIÓN PLANTA GARAJE

E: 1/100



4 Bed Property For Residential in Alicante

€895,000

Teulada

Ref: 86437

- Garage
- Solarium
- Parking
- Pool Own
- Garden
- Wardrobes cupboard
- Residencial
- Terrace
- Armored Door
- Automatic Doors

Telephone: +351 213 471 603
 Email: info@portugalhomes.com

Avenida da Liberdade 67B, 5th Floor, 1250-140 Lisboa, Portugal Licence AMI - 14414 | APEMIP 5940



Property Description

MODERN STYLE VILLA WITH BEAUTIFUL SEA VIEWS IN MORAIRA The house is a short drive from the center of Moraira and its beautiful beaches, as well as supermarkets, shops, bars, restaurants and entertainment areas. An exclusive design villa located in the so-called "pearl of the Mediterranean", one of the most exclusive areas of the entire Costa Blanca: sea and mountains, golf and water sports, hospitals and international schools, nature and leisure, all in an environment natural and without noise, with 300 days of sunshine a year and an average annual temperature of almost 20°C. One of the best choices for your vacation or permanent residence. The villa, which will be built with the highest quality materials, will have 3 floors: -Basement floor: it consists of a garage with capacity for 2 cars and a storage room. From this floor you can go up to the upper floors by means of an internal staircase. -Ground floor: it is distributed in entrance hall, modern kitchen and open to the spacious living-dining room which has access to the porch and the pool. Pantry, guest toilet, 1 bedroom and bathroom en suite. -Top floor: 3 bedrooms, one of them with bathroom en suite and another bathroom to share. Among the finishes, the following stand out: - Modern kitchen with island, open to the dining room, equipped with Bosch appliances or similar with direct access to the outdoor terrace and pool area. - Central air conditioning hot / cold through ducts. - Pre-installation of central heating throughout the house. - Pre-installation of alarm inside the house. - Aluminum exterior carpentry, with large windows with security glass with Climalit-type camera. Main entrance door with security lock. Exterior shutters in bedrooms and other rooms. - Suspended toilets and bathroom furniture. - Large pool, rectangular in shape, with pre-installation for air conditioning.

Gallery

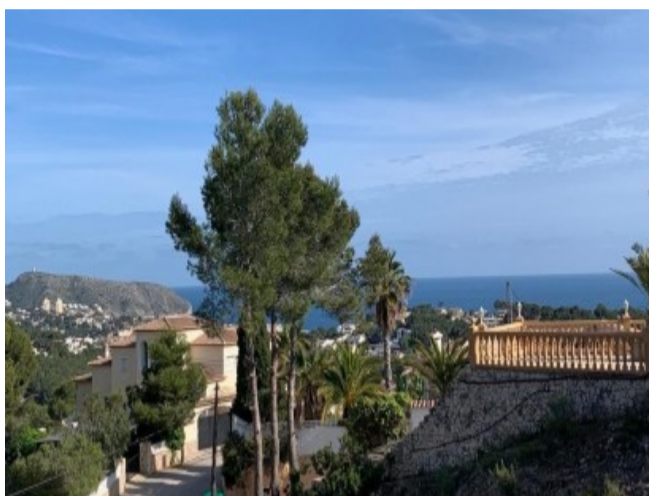
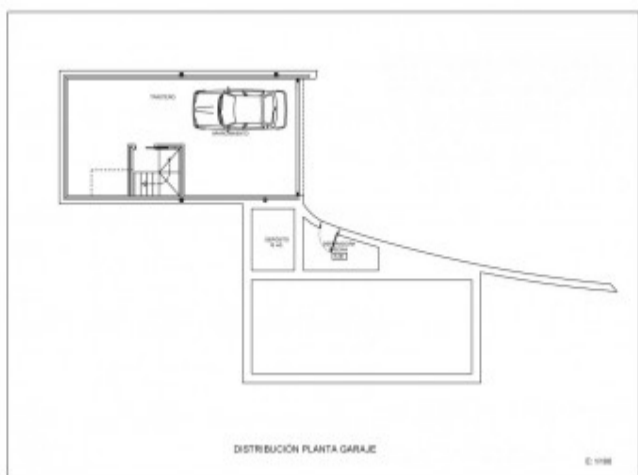

Additional Details

Attributes

Status Available	Land Area 292m2
----------------------------	---------------------------

Property Features

Garage	Garden	Terrace
Solarium	Wardrobes cupboard	Armored Door
Parking	Residencial	Automatic Doors
Pool Own		